

PLAT OF SURVEY

MILL LAKE
(LAUDERDALE LAKES)

LAKE ELEVATION 8/8/00 = 884.68'
100 YEAR FLOOD ELEVATION = 886.00'

LOTS 43, 44, 46, 47, 48
AND OTHER LANDS LOCATED IN
THE LAUDERDALE HEIGHTS
SUBDIVISION, LOCATED IN
SECTION 35 TOWN 4 NORTH,
RANGE 16 EAST, WALWORTH
COUNTY, WISCONSIN.

PLATTED AS COMMUNITY PARK
L H - 32

BASIS FOR BEARINGS

THE NORTHERLY LINE OF
WILKINSON ROAD WAS
ASSUMED TO BEAR N 59° E
AS PLATTED

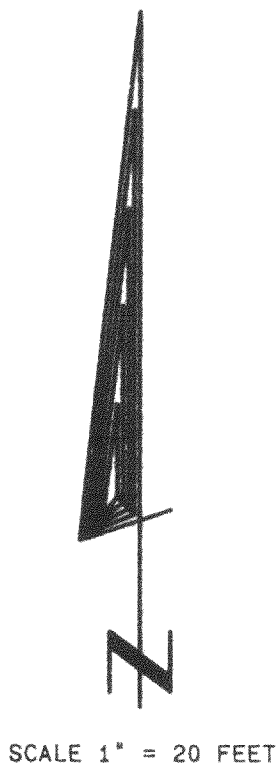

SCALE 1" = 20 FEET

LEGAL DESCRIPTION - (provided by client from title policy)

LOTS 43, 44, 46, 47, AND 48 IN LAUDERDALE HEIGHTS SUBDIVISION, ACCORDING TO THE RECORDED PLAT THEREOF, RECORDED IN VOLUME 8 OF PLATS AT PAGES 22 AND 23. ALSO A PARCEL OF LAND IN LAUDERDALE HEIGHTS DESCRIBED AS FOLLOWS: BEGINNING THE MOST WESTERLY CORNER OF LOT 31 OF LAUDERDALE HEIGHTS SUBDIVISION AS PER PLAT OF SAID TRACT RECORDED IN VOLUME 8 OF PLATS ON PAGES 22 AND 23, BEING ALSO ON THE MOST SOUTHERLY LINE OF LOT 31; THENCE WESTERLY, BEING ALONG SAID LINE PRODUCED TO AN IRON MONUMENT AT THE INTERSECTION OF SAID LINE PRODUCED AND THE SOUTHEASTERLY LINE OF WILKINSON'S ROAD; THENCE NORTH 59° EAST, BEING ALONG THE SOUTHEASTERLY LINE OF SAID ROAD TO AN ANGLE ON THE WESTERLY LINE OF LOT 31; THENCE SOUTHWESTERLY ALONG THE WESTERLY LINE OF LOT 31, 46.5 FEET TO THE PLACE OF BEGINNING.

ALSO COMMENCING AT THE SOUTHEASTERN MOST CORNER OF LOT 48 OF LAUDERDALE HEIGHTS SUBDIVISION, AS RECORDED IN THE REGISTER OF DEEDS OFFICE; THENCE NORTHEASTERLY ALONG THE SOUTHERLY LINE OF LOTS 48, 47 AND 46 OF SAID SUBDIVISION TO THE SOUTHEAST CORNER OF SAID LOT 46; THENCE MEANDERING IN FIRST A SOUTHEASTERLY DIRECTION AND THEN IN A SOUTHWESTERLY DIRECTION ALONG THE WESTERLY LINE OF LOT 43 IN SAID SUBDIVISION TO THE SOUTHERN MOST CORNER OF LOT 43; THENCE SOUTHWEST IN THE NORTH LINE OF WILKINSON STREET TO THE MOST EASTERN CORNER OF LOT 44 IN SAID SUBDIVISION; THENCE MEANDERING ALONG THE NORTHERLY LINE OF LOT 44 IN SAID SUBDIVISION TO THE PLACE OF BEGINNING.

OWNERS: FRED AND PAMELA BRODERSEN
9448 COTTEN CT.
SANIBEL, FL. 33957

SUBJECT PROPERTY ADDRESS:
N7439 COUNTRY CLUB DR.
ELKHORN, WI. 53121

ORDERED BY: ATTY. PAUL E. KREMER
P.O. BOX 470
ELKHORN, WI. 53121

LINE	BEARING	DISTANCE
L1	S 59°00'00" W	55.00
L2	S 61°52'03" W	20.00
L3	S 21°16'04" W	21.84

Legend

- FOUND IRON PIPE
- FOUND IRON ROD
- FOUND BRASS CAPPED MONUMENT
- FOUND CONCRETE MONUMENT
- CHISEL CUT IN CONCRETE
- SET IRON ROD, 24" LONG, WEIGHING 1.5 LBS. LINEAL FT., 1 1/4" DIA.
- SET IRON ROD, 30" LONG, WEIGHING 4.5 LBS. LINEAL FT., 1 1/4" DIA.
- RECORDED AS DIMENSION
- EXISTING FENCE

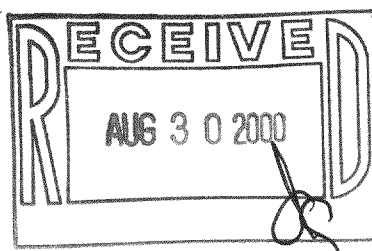

SCALE: 1" = 20 FEET

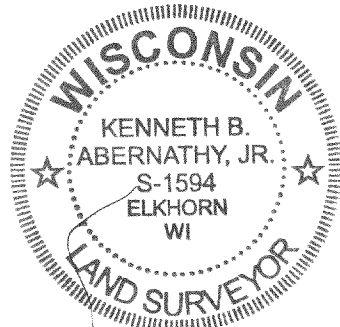

I hereby certify that the above described property has been surveyed by me in strict accordance with the laws of the State of Wisconsin, and that the above map is a true and correct representation of the same, and that the size and location of the property, its exterior boundaries, the location of all visible structures and improvements, and all other facts shown thereon, are true and correct.

KENNETH B. ABERNATHY, JR.
WISCONSIN REGISTERED LAND SURVEYOR,
S-1594
Date: August 19, 2000 Job No. 00-801